

MC

(MALE CONNECTOR)

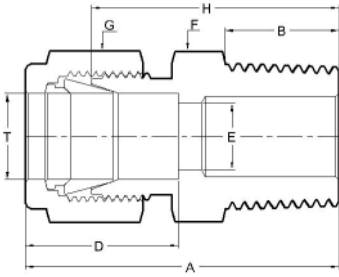

公制 (METRIC)

T TUBE O.D.	PT-NPT MALE PIPE SIZE	PART NO.	A	B	D	E	F	G	H
3	1/8	MC301	31.7	10.0	12.9	2.5	12	7/16	25.0
3	1/4	MC302	34.7	13.0	12.9	2.5	14	7/16	28.0
4	1/8	MC401	32.1	10.0	13.7	2.5	12	12	25.0
4	1/4	MC402	35.1	13.0	13.7	2.5	14	12	28.0
4	3/8	MC403	37.1	14.0	13.7	2.5	17	12	30.0
4	1/2	MC404	41.1	17.0	13.7	2.5	22	12	34.0
4	3/4	MC406	44.1	19.0	13.7	2.5	27	9/16	37.0
4	1	MC408	50.1	22.0	13.7	2.5	35	9/16	43.0
6	1/8	MC601	33.6	10.0	15.3	5.0	12	9/16	26.0
6	1/4	MC602	36.6	13.0	15.3	5.0	14	9/16	29.0
6	3/8	MC603	38.6	14.0	15.3	5.0	17	9/16	31.0
6	1/2	MC604	42.6	17.0	15.3	5.0	22	9/16	35.0
6	3/4	MC606	45.6	19.0	15.3	5.0	27	9/16	38.0
6	1	MC608	51.6	22.0	15.3	5.0	35	9/16	44.0
8	1/8	MC801	34.8	10.0	16.2	5.0	14	5/8	27.0
8	1/4	MC802	37.8	13.0	16.2	6.0	14	5/8	30.0
8	3/8	MC803	39.8	14.0	16.2	6.0	17	5/8	32.0
8	1/2	MC804	43.8	17.0	16.2	6.0	22	5/8	36.0
8	3/4	MC806	46.8	19.0	16.2	6.0	27	5/8	39.0
8	1	MC808	52.8	22.0	16.2	6.0	35	5/8	45.0
10	1/8	MC1001	36.9	10.0	17.2	5.0	17	19	29.0
10	1/4	MC1002	39.9	13.0	17.2	7.0	17	19	32.0
10	3/8	MC1003	40.9	14.0	17.2	8.0	17	19	33.0
10	1/2	MC1004	44.9	17.0	17.2	8.0	22	19	37.0
10	3/4	MC1006	47.9	19.0	17.2	8.0	27	19	40.0
10	1	MC1008	53.9	22.0	17.2	8.0	35	19	46.0
12	1/8	MC1201	39.7	10.0	22.8	5.0	19	7/8	30.0
12	1/4	MC1202	42.7	13.0	22.8	7.0	19	7/8	33.0
12	3/8	MC1203	43.7	14.0	22.8	10.0	19	7/8	34.0
12	1/2	MC1204	46.7	17.0	22.8	10.0	22	7/8	37.0
12	3/4	MC1206	49.7	19.0	22.8	10.0	27	7/8	40.0
12	1	MC1208	55.7	22.0	22.8	10.0	35	7/8	46.0
14	1/8	MC1401	40.4	10.0	24.4	5.0	24	25	30.0
14	1/4	MC1402	43.4	13.0	24.4	7.0	24	25	33.0
14	3/8	MC1403	44.4	14.0	24.4	9.5	24	25	34.0
14	1/2	MC1404	47.4	17.0	24.4	12.0	24	25	37.0
14	3/4	MC1406	50.4	19.0	24.4	12.0	27	25	40.0
14	1	MC1408	56.4	22.0	24.4	12.0	35	25	46.0
15	1/8	MC1501	40.5	10.0	24.4	5.0	24	25	30.0
15	1/4	MC1502	43.5	13.0	24.4	7.0	24	25	33.0
15	3/8	MC1503	44.5	14.0	24.4	9.5	24	25	34.0
15	1/2	MC1504	47.5	17.0	24.4	12.0	24	25	37.0
15	3/4	MC1506	50.5	19.0	24.4	12.0	27	25	40.0
15	1	MC1508	56.5	22.0	24.4	12.0	35	25	46.0
16	1/8	MC1601	40.7	10.0	24.4	5.0	24	25	30.0
16	1/4	MC1602	43.7	13.0	24.4	7.0	24	25	33.0
16	3/8	MC1603	44.7	14.0	24.4	9.5	24	25	34.0
16	1/2	MC1604	47.7	17.0	24.4	12.0	24	25	37.0
16	3/4	MC1606	50.7	19.0	24.4	14.0	27	25	40.0
16	1	MC1608	56.7	22.0	24.4	14.0	35	25	46.0
18	1/8	MC1801	41.4	10.0	24.4	5.0	27	30	31.0
18	1/4	MC1802	44.4	13.0	24.4	7.0	27	30	34.0
18	3/8	MC1803	45.4	14.0	24.4	9.5	27	30	35.0
18	1/2	MC1804	48.4	17.0	24.4	12.0	27	30	38.0
18	3/4	MC1806	50.4	19.0	24.4	15.0	27	30	40.0
18	1	MC1808	56.4	22.0	24.4	16.0	35	30	46.0
20	1/8	MC2001	41.0	10.0	26.0	5.0	30	32	32.0
20	1/4	MC2002	44.0	13.0	26.0	7.0	30	32	35.0
20	3/8	MC2003	45.0	14.0	26.0	9.5	30	32	36.0
20	1/2	MC2004	48.0	17.0	26.0	12.0	30	32	39.0
20	3/4	MC2006	50.0	19.0	26.0	15.0	30	32	41.0
20	1	MC2008	55.0	22.0	26.0	18.0	35	32	46.0
22	1/8	MC2201	41.3	10.0	26.0	5.0	30	32	32.0
22	1/4	MC2202	44.3	13.0	26.0	7.0	30	32	35.0
22	3/8	MC2203	45.3	14.0	26.0	9.5	30	32	36.0
22	1/2	MC2204	48.3	17.0	26.0	12.0	30	32	39.0
22	3/4	MC2206	50.3	19.0	26.0	15.0	30	32	41.0
22	1	MC2208	55.3	22.0	26.0	18.0	35	32	46.0
25	1/8	MC2501	48.4	10.0	31.3	5.0	35	1-1/2	36.0
25	1/4	MC2502	51.4	13.0	31.3	7.0	35	1-1/2	39.0
25	3/8	MC2503	52.4	14.0	31.3	9.5	35	1-1/2	40.0
25	1/2	MC2504	55.4	17.0	31.3	12.0	35	1-1/2	43.0
25	3/4	MC2506	57.4	19.0	31.3	15.0	35	1-1/2	45.0
25	1	MC2508	60.4	22.0	31.3	20.0	35	1-1/2	48.0

ALL DIMENSIONS ARE IN MILLIMETERS UNLESS SPECIFIC. (除非另有說明，否則所有尺寸單位均為MM)
 IN COLUMN G, FRACTION NUMBERS MEAN INCH SIZE. (G欄數值若是分數，表示其單位是INCH)
 DIMENSIONS SHOWN ARE FOR REFERENCE ONLY AND SUBJECT TO CHANGE. (上述尺寸僅供參考，修改不另行通知)

MC

(MALE CONNECTOR)

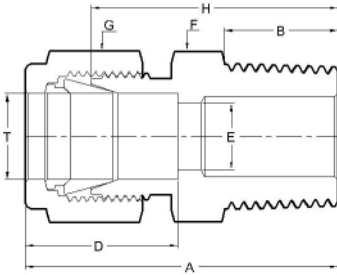

英制 (FRACTIONAL)

T TUBE O.D.	PT-NPT MALE PIPE SIZE	PART NO.	A	B	D	E	F	G	H
1/16	1/8	MC00501	27.0	10.0	8.6	1.5	10	10	23.0
1/16	1/4	MC00502	30.0	13.0	8.6	1.5	14	10	26.0
1/8	1/8	MC0101	31.9	10.0	12.7	2.5	10	7/16	25.0
1/8	1/4	MC0102	34.9	13.0	12.7	2.5	14	7/16	28.0
1/8	3/8	MC0103	36.9	14.0	12.7	2.5	17	7/16	30.0
1/8	1/2	MC0104	40.9	17.0	12.7	2.5	22	7/16	34.0
1/8	3/4	MC0106	43.9	19.0	12.7	2.5	27	7/16	37.0
1/8	1	MC0108	49.9	22.0	12.7	2.5	35	7/16	43.0
3/16	1/8	MC01501	31.9	10.0	13.7	2.5	12	12	25.0
3/16	1/4	MC01502	34.9	13.0	13.7	2.5	14	12	28.0
1/4	1/8	MC0201	33.8	10.0	15.2	5.0	12	9/16	26.0
1/4	1/4	MC0202	36.8	13.0	15.2	5.0	14	9/16	29.0
1/4	3/8	MC0203	38.8	14.0	15.2	5.0	17	9/16	31.0
1/4	1/2	MC0204	42.8	17.0	15.2	5.0	22	9/16	35.0
1/4	3/4	MC0206	45.8	19.0	15.2	5.0	27	9/16	38.0
1/4	1	MC0208	51.8	22.0	15.2	5.0	35	9/16	44.0
3/8	1/8	MC0301	35.7	10.0	16.8	5.0	14	11/16	28.0
3/8	1/4	MC0302	38.7	13.0	16.8	7.7	14	11/16	31.0
3/8	3/8	MC0303	40.7	14.0	16.8	7.7	17	11/16	33.0
3/8	1/2	MC0304	44.7	17.0	16.8	7.7	22	11/16	37.0
3/8	3/4	MC0306	47.7	19.0	16.8	7.7	27	11/16	40.0
3/8	1	MC0308	53.7	22.0	16.8	7.7	35	11/16	46.0
1/2	1/8	MC0401	39.9	10.0	22.9	5.0	19	7/8	30.0
1/2	1/4	MC0402	42.9	13.0	22.9	7.0	19	7/8	33.0
1/2	3/8	MC0403	43.9	14.0	22.9	10.0	19	7/8	34.0
1/2	1/2	MC0404	46.9	17.0	22.9	10.0	22	7/8	37.0
1/2	3/4	MC0406	49.9	19.0	22.9	10.0	27	7/8	40.0
1/2	1	MC0408	55.9	22.0	22.9	10.0	35	7/8	46.0
5/8	3/8	MC0503	44.4	14.0	24.4	10.0	24	25	34.0
5/8	1/2	MC0504	48.4	17.0	24.4	12.0	24	25	38.0
5/8	3/4	MC0506	50.4	19.0	24.4	14.0	27	25	40.0
3/4	1/8	MC0601	41.9	10.0	24.4	5.0	27	1-1/8	31.0
3/4	1/4	MC0602	44.9	13.0	24.4	7.0	27	1-1/8	34.0
3/4	3/8	MC0603	45.9	14.0	24.4	9.5	27	1-1/8	35.0
3/4	1/2	MC0604	48.9	17.0	24.4	12.0	27	1-1/8	38.0
3/4	3/4	MC0606	50.9	19.0	24.4	15.0	27	1-1/8	40.0
3/4	1	MC0608	56.9	22.0	24.4	16.0	35	1-1/8	46.0
1	1/8	MC0801	48.4	10.0	31.2	5.0	35	1-1/2	36.0
1	1/4	MC0802	51.4	13.0	31.2	7.0	35	1-1/2	39.0
1	3/8	MC0803	52.4	14.0	31.2	9.5	35	1-1/2	40.0
1	1/2	MC0804	55.4	17.0	31.2	12.0	35	1-1/2	43.0
1	3/4	MC0806	57.4	19.0	31.2	16.0	35	1-1/2	45.0
1	1	MC0808	60.4	22.0	31.2	20.0	35	1-1/2	48.0

ALL DIMENSIONS ARE IN MILLIMETERS UNLESS SPECIFIC. (除非另有說明，否則所有尺寸單位均為MM)
 IN COLUMN G, FRACTION NUMBERS MEAN INCH SIZE. (G欄數值若是分數，表示其單位是INCH)
 DIMENSIONS SHOWN ARE FOR REFERENCE ONLY AND SUBJECT TO CHANGE. (上述尺寸僅供參考，修改不另行通知)