

FC

(FEMALE CONNECTOR)

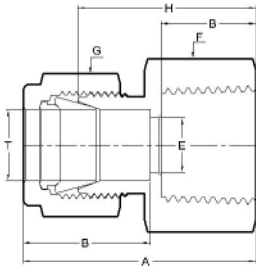

公制 (METRIC)

| T TUBE O.D. | PT-NPT FEMALE PIPE SIZE | PART NO. | A | B | D | E | F | G | H |
|-------------------|----------------------------------|-------------|------|------|------|------|----|-------|------|
| 4 | 1/8 | FC401 | 31.1 | 12.0 | 13.7 | 2.5 | 14 | 12 | 24.0 |
| 4 | 1/4 | FC402 | 32.1 | 13.0 | 13.7 | 2.5 | 17 | 12 | 25.0 |
| 4 | 3/8 | FC403 | 33.1 | 14.0 | 13.7 | 2.5 | 22 | 12 | 26.0 |
| 4 | 1/2 | FC404 | 36.1 | 17.0 | 13.7 | 2.5 | 27 | 12 | 29.0 |
| 4 | 3/4 | FC406 | 38.1 | 18.0 | 13.7 | 2.5 | 32 | 12 | 31.0 |
| 4 | 1 | FC408 | 45.1 | 24.0 | 13.7 | 2.5 | 41 | 12 | 38.0 |
| 6 | 1/8 | FC601 | 32.6 | 12.0 | 15.3 | 5.0 | 14 | 9/16 | 25.0 |
| 6 | 1/4 | FC602 | 33.6 | 13.0 | 15.3 | 5.0 | 17 | 9/16 | 26.0 |
| 6 | 3/8 | FC603 | 34.6 | 14.0 | 15.3 | 5.0 | 22 | 9/16 | 27.0 |
| 6 | 1/2 | FC604 | 37.6 | 17.0 | 15.3 | 5.0 | 27 | 9/16 | 30.0 |
| 6 | 3/4 | FC606 | 39.6 | 18.0 | 15.3 | 5.0 | 32 | 9/16 | 32.0 |
| 6 | 1 | FC608 | 46.6 | 24.0 | 15.3 | 5.0 | 41 | 9/16 | 39.0 |
| 8 | 1/8 | FC801 | 33.8 | 12.0 | 16.2 | 6.0 | 14 | 5/8 | 26.0 |
| 8 | 1/4 | FC802 | 34.8 | 13.0 | 16.2 | 6.0 | 17 | 5/8 | 27.0 |
| 8 | 3/8 | FC803 | 35.8 | 14.0 | 16.2 | 6.0 | 22 | 5/8 | 28.0 |
| 8 | 1/2 | FC804 | 38.8 | 17.0 | 16.2 | 6.0 | 27 | 5/8 | 31.0 |
| 8 | 3/4 | FC806 | 40.8 | 18.0 | 16.2 | 6.0 | 32 | 5/8 | 33.0 |
| 8 | 1 | FC808 | 47.8 | 24.0 | 16.2 | 6.0 | 41 | 5/8 | 40.0 |
| 10 | 1/8 | FC1001 | 34.9 | 12.0 | 17.2 | 8.0 | 17 | 19 | 27.0 |
| 10 | 1/4 | FC1002 | 35.9 | 13.0 | 17.2 | 8.0 | 17 | 19 | 28.0 |
| 10 | 3/8 | FC1003 | 36.9 | 14.0 | 17.2 | 8.0 | 22 | 19 | 29.0 |
| 10 | 1/2 | FC1004 | 39.9 | 17.0 | 17.2 | 8.0 | 27 | 19 | 32.0 |
| 10 | 3/4 | FC1006 | 41.9 | 18.0 | 17.2 | 8.0 | 32 | 19 | 34.0 |
| 10 | 1 | FC1008 | 48.9 | 24.0 | 17.2 | 8.0 | 41 | 19 | 41.0 |
| 12 | 1/8 | FC1201 | 38.7 | 12.0 | 22.8 | 8.0 | 19 | 7/8 | 29.0 |
| 12 | 1/4 | FC1202 | 38.7 | 13.0 | 22.8 | 10.0 | 19 | 7/8 | 29.0 |
| 12 | 3/8 | FC1203 | 38.7 | 14.0 | 22.8 | 10.0 | 22 | 7/8 | 29.0 |
| 12 | 1/2 | FC1204 | 43.7 | 17.0 | 22.8 | 10.0 | 27 | 7/8 | 34.0 |
| 12 | 3/4 | FC1206 | 43.7 | 18.0 | 22.8 | 10.0 | 32 | 7/8 | 34.0 |
| 12 | 1 | FC1208 | 50.7 | 24.0 | 22.8 | 10.0 | 41 | 7/8 | 41.0 |
| 14 | 1/8 | FC1401 | 40.4 | 12.0 | 24.4 | 8.0 | 24 | 25 | 30.0 |
| 14 | 1/4 | FC1402 | 40.4 | 13.0 | 24.4 | 12.0 | 24 | 25 | 30.0 |
| 14 | 3/8 | FC1403 | 41.4 | 14.0 | 24.4 | 12.0 | 24 | 25 | 31.0 |
| 14 | 1/2 | FC1404 | 42.4 | 17.0 | 24.4 | 12.0 | 27 | 25 | 32.0 |
| 14 | 3/4 | FC1406 | 44.4 | 18.0 | 24.4 | 12.0 | 32 | 25 | 34.0 |
| 14 | 1 | FC1408 | 51.4 | 24.0 | 24.4 | 12.0 | 41 | 25 | 41.0 |
| 15 | 1/8 | FC1501 | 40.5 | 12.0 | 24.4 | 8.0 | 24 | 25 | 30.0 |
| 15 | 1/4 | FC1502 | 40.5 | 13.0 | 24.4 | 12.0 | 24 | 25 | 30.0 |
| 15 | 3/8 | FC1503 | 41.5 | 14.0 | 24.4 | 12.0 | 24 | 25 | 31.0 |
| 15 | 1/2 | FC1504 | 42.5 | 17.0 | 24.4 | 12.0 | 27 | 25 | 32.0 |
| 15 | 3/4 | FC1506 | 44.5 | 18.0 | 24.4 | 12.0 | 32 | 25 | 34.0 |
| 15 | 1 | FC1508 | 51.5 | 24.0 | 24.4 | 12.0 | 41 | 25 | 41.0 |
| 16 | 1/8 | FC1601 | 40.7 | 12.0 | 24.4 | 8.0 | 24 | 25 | 30.0 |
| 16 | 1/4 | FC1602 | 40.7 | 13.0 | 24.4 | 11.0 | 24 | 25 | 30.0 |
| 16 | 3/8 | FC1603 | 41.7 | 14.0 | 24.4 | 14.0 | 24 | 25 | 31.0 |
| 16 | 1/2 | FC1604 | 42.7 | 17.0 | 24.4 | 14.0 | 27 | 25 | 32.0 |
| 16 | 3/4 | FC1606 | 44.7 | 18.0 | 24.4 | 14.0 | 32 | 25 | 34.0 |
| 16 | 1 | FC1608 | 51.7 | 24.0 | 24.4 | 14.0 | 41 | 25 | 41.0 |
| 18 | 3/8 | FC1803 | 42.4 | 14.0 | 24.4 | 14.0 | 27 | 30 | 32.0 |
| 18 | 1/2 | FC1804 | 42.4 | 17.0 | 24.4 | 16.0 | 27 | 30 | 32.0 |
| 18 | 3/4 | FC1806 | 44.4 | 18.0 | 24.4 | 16.0 | 32 | 30 | 34.0 |
| 18 | 1 | FC1808 | 51.4 | 24.0 | 24.4 | 16.0 | 41 | 30 | 41.0 |
| 20 | 1/2 | FC2004 | 44.0 | 17.0 | 26.0 | 18.0 | 30 | 32 | 35.0 |
| 20 | 3/4 | FC2006 | 44.0 | 18.0 | 26.0 | 18.0 | 32 | 32 | 35.0 |
| 20 | 1 | FC2008 | 50.0 | 24.0 | 26.0 | 18.0 | 41 | 32 | 41.0 |
| 22 | 1/2 | FC2204 | 44.3 | 17.0 | 26.0 | 18.0 | 30 | 32 | 35.0 |
| 22 | 3/4 | FC2206 | 44.3 | 18.0 | 26.0 | 18.0 | 32 | 32 | 35.0 |
| 22 | 1 | FC2208 | 50.3 | 24.0 | 26.0 | 18.0 | 41 | 32 | 41.0 |
| 25 | 3/4 | FC2506 | 54.4 | 18.0 | 31.3 | 22.0 | 35 | 1-1/2 | 42.0 |
| 25 | 1 | FC2508 | 57.4 | 24.0 | 31.3 | 22.0 | 41 | 1-1/2 | 45.0 |

ALL DIMENSIONS ARE IN MILLIMETERS UNLESS SPECIFIC (除非另有說明，否則所有尺寸單位均為MM)
 IN COLUMN G, FRACTION NUMBERS MEAN INCH SIZE. (G欄數值若是分數，表示其單位是INCH)
 DIMENSIONS SHOWN ARE FOR REFERENCE ONLY AND SUBJECT TO CHANGE. (上述尺寸僅供參考，修改不另行通知)

FC

(FEMALE CONNECTOR)

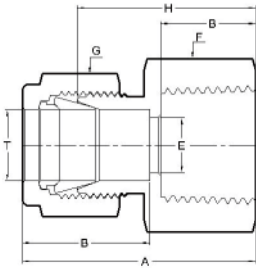

英制 (FRACTIONAL)

| T TUBE O.D. | PT-NPT FEMALE PIPE SIZE | PART NO. | A | B | D | E | F | G | H |
|-------------------|----------------------------------|-------------|------|------|------|------|----|-------|------|
| 1/8 | 1/8 | FC0101 | 29.9 | 12.0 | 12.7 | 2.5 | 14 | 7/16 | 23.0 |
| 1/8 | 1/4 | FC0102 | 31.9 | 13.0 | 12.7 | 2.5 | 17 | 7/16 | 25.0 |
| 1/8 | 3/8 | FC0103 | 32.9 | 14.0 | 12.7 | 2.5 | 22 | 7/16 | 26.0 |
| 1/8 | 1/2 | FC0104 | 35.9 | 17.0 | 12.7 | 2.5 | 27 | 7/16 | 29.0 |
| 1/8 | 3/4 | FC0106 | 37.9 | 18.0 | 12.7 | 2.5 | 32 | 7/16 | 31.0 |
| 1/8 | 1 | FC0108 | 44.9 | 24.0 | 12.7 | 2.5 | 41 | 7/16 | 38.0 |
| 1/4 | 1/8 | FC0201 | 31.8 | 12.0 | 15.2 | 5.0 | 14 | 9/16 | 24.0 |
| 1/4 | 1/4 | FC0202 | 33.8 | 13.0 | 15.2 | 5.0 | 17 | 9/16 | 26.0 |
| 1/4 | 3/8 | FC0203 | 34.8 | 14.0 | 15.2 | 5.0 | 22 | 9/16 | 27.0 |
| 1/4 | 1/2 | FC0204 | 37.8 | 17.0 | 15.2 | 5.0 | 27 | 9/16 | 30.0 |
| 1/4 | 3/4 | FC0206 | 39.8 | 18.0 | 15.2 | 5.0 | 32 | 9/16 | 32.0 |
| 1/4 | 1 | FC0208 | 46.8 | 24.0 | 15.2 | 5.0 | 41 | 9/16 | 39.0 |
| 3/8 | 1/8 | FC0301 | 33.7 | 12.0 | 16.8 | 7.7 | 14 | 11/16 | 26.0 |
| 3/8 | 1/4 | FC0302 | 35.7 | 13.0 | 16.8 | 7.7 | 17 | 11/16 | 28.0 |
| 3/8 | 3/8 | FC0303 | 36.7 | 14.0 | 16.8 | 7.7 | 22 | 11/16 | 29.0 |
| 3/8 | 1/2 | FC0304 | 39.7 | 17.0 | 16.8 | 7.7 | 27 | 11/16 | 32.0 |
| 3/8 | 3/4 | FC0306 | 41.7 | 18.0 | 16.8 | 7.7 | 32 | 11/16 | 34.0 |
| 3/8 | 1 | FC0308 | 48.7 | 24.0 | 16.8 | 7.7 | 41 | 11/16 | 41.0 |
| 1/2 | 1/8 | FC0401 | 36.9 | 12.0 | 22.9 | 8.0 | 19 | 7/8 | 27.0 |
| 1/2 | 1/4 | FC0402 | 39.9 | 13.0 | 22.9 | 10.0 | 19 | 7/8 | 30.0 |
| 1/2 | 3/8 | FC0403 | 40.9 | 14.0 | 22.9 | 10.0 | 22 | 7/8 | 31.0 |
| 1/2 | 1/2 | FC0404 | 41.9 | 17.0 | 22.9 | 10.0 | 27 | 7/8 | 32.0 |
| 1/2 | 3/4 | FC0406 | 43.9 | 18.0 | 22.9 | 10.0 | 32 | 7/8 | 34.0 |
| 1/2 | 1 | FC0408 | 50.9 | 24.0 | 22.9 | 10.0 | 41 | 7/8 | 41.0 |
| 5/8 | 3/8 | FC0503 | 41.4 | 15.0 | 24.4 | 10.0 | 24 | 25 | 31.0 |
| 5/8 | 1/2 | FC0504 | 42.4 | 17.0 | 24.4 | 14.0 | 27 | 25 | 32.0 |
| 5/8 | 3/4 | FC0506 | 44.4 | 18.0 | 24.4 | 14.0 | 32 | 25 | 34.0 |
| 3/4 | 1/8 | FC0601 | 39.9 | 12.0 | 24.4 | 8.0 | 27 | 1-1/8 | 29.0 |
| 3/4 | 1/4 | FC0602 | 41.9 | 13.0 | 24.4 | 10.0 | 27 | 1-1/8 | 31.0 |
| 3/4 | 3/8 | FC0603 | 41.9 | 14.0 | 24.4 | 14.0 | 27 | 1-1/8 | 31.0 |
| 3/4 | 1/2 | FC0604 | 44.9 | 17.0 | 24.4 | 16.0 | 27 | 1-1/8 | 34.0 |
| 3/4 | 3/4 | FC0606 | 44.9 | 18.0 | 24.4 | 16.0 | 32 | 1-1/8 | 34.0 |
| 3/4 | 1 | FC0608 | 51.9 | 24.0 | 24.4 | 16.0 | 41 | 1-1/8 | 41.0 |
| 1 | 3/4 | FC0806 | 52.4 | 18.0 | 31.2 | 22.0 | 35 | 1-1/2 | 40.0 |
| 1 | 1 | FC0808 | 57.4 | 24.0 | 31.2 | 22.0 | 41 | 1-1/2 | 45.0 |

ALL DIMENSIONS ARE IN MILLIMETERS UNLESS SPECIFIC. (除非另有說明，否則所有尺寸單位均為MM)
 IN COLUMN G, FRACTION NUMBERS MEAN INCH SIZE. (G欄數值若是分數，表示其單位是INCH)
 DIMENSIONS SHOWN ARE FOR REFERENCE ONLY AND SUBJECT TO CHANGE. (上述尺寸僅供參考，修改不另行通知)